

CONTROL ROOM

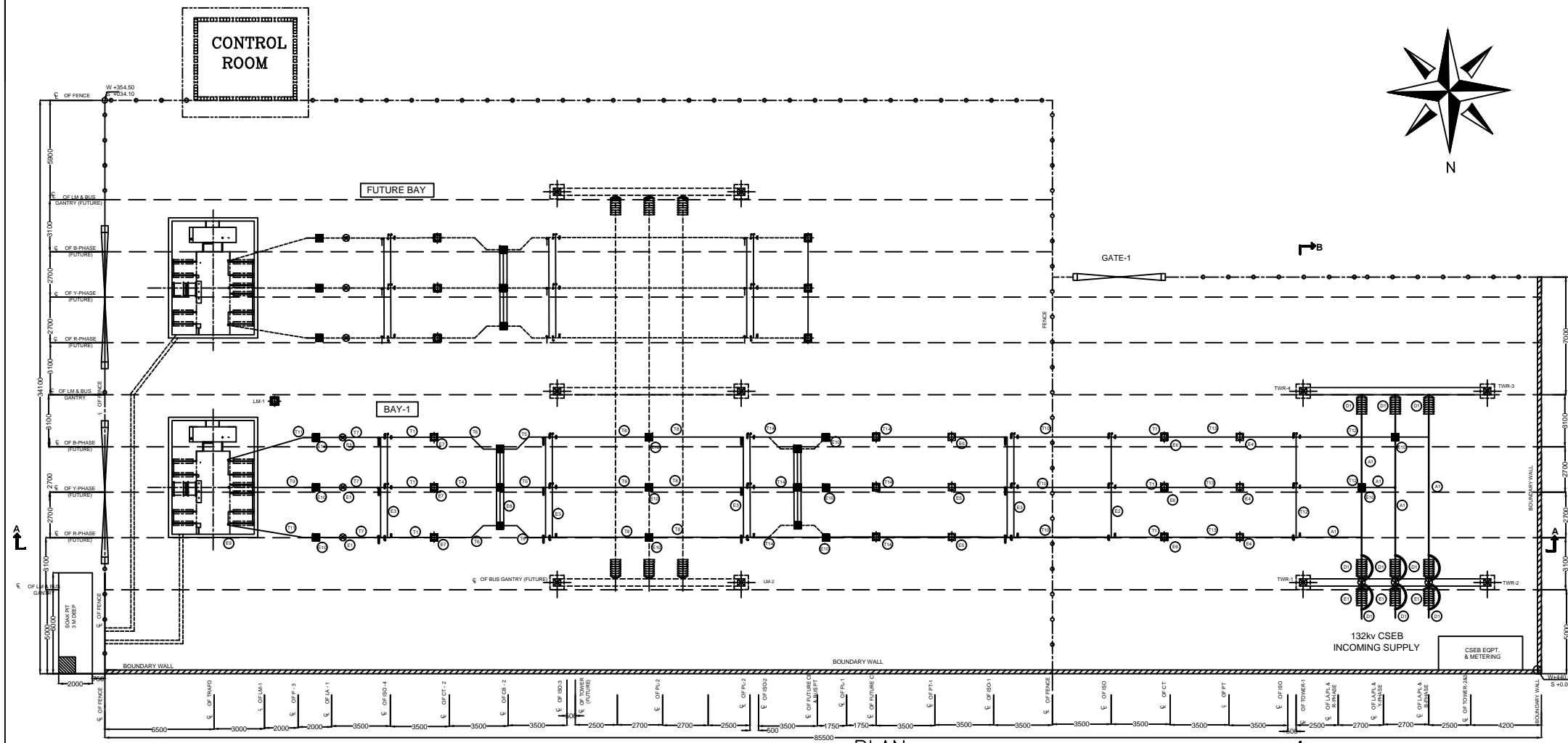
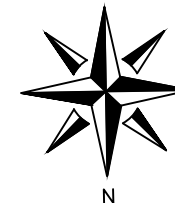

PLAN

YARD EQUIPMENT DETAIL

S.NO.	EQPT. NO.	LEGEND	EQUIPMENT DESCRIPTION
01	LA	LA-1	METALOXIDE LIGHTENING ARRESTER CLASS-3 WITH GRADE RINGS, SURGE COUNTER
02	ISO	ISO	ELECTRICALLY OPERATED ISOLATOR WITHOUT EARTH SWITCH FOR CSEB YARD
03	ISO-1, ISO-2, ISO-3, ISO-4	ISO-1, ISO-2, ISO-3, ISO-4	ELECTRICALLY OPERATED ISOLATOR WITH MANUAL EARTH SWITCH
04	PT	PT	POTENTIAL TRANSFORMER FOR CSEB METERING
05	PT-1	PT-1	POTENTIAL TRANSFORMER
06	CT	CT	CURRENT TRANSFORMER FOR CSEB METERING CORE 1 & 2 METERING
07	CT-2	CT-2	CURRENT TRANSFORMER CORE 1- METERING CORE 2- PROTECTION CORE 3- PROTECTION CORE 4- PROTECTION
08	CB-2	CB-2	SF6 CIRCUIT BREAKER
09	TRAF0	TRAF0	GRID TRANSFORMER (NOT IN SWITCHYARD PACKAGE)
10	PL-PL-1, PL-2, PL-3	PL-1, PL-2, PL-3	POST INSULATOR

CLAMPS & CONNECTORS

S.NO.	EQPT. NO.	DESCRIPTION
01	C	TEE CONNECTOR TO SUIT ACSR 'MOOSE' ON MAIN WAYS AND BRANCH WAYS.
02	C	TEE CONNECTOR TO SUIT 3" DETAIL TUBE ON MAIN WAYS AND ACSR 'MOOSE' ON BRANCH WAYS.
03	C	TERMINAL CONNECTOR ON ISO TO SUIT 3" IPS AL. TUBE (EXPANSION TYPE)
04	C	TERMINAL CONNECTOR ON ISO TO SUIT ACSR MOOSE.
05	C	TERMINAL CONNECTOR ON CB TO SUIT 3" IPS AL. TUBE (EXPANSION TYPE)
06	C	TERMINAL CONNECTOR ON CT TO SUIT 3" IPS AL. TUBE (RIGID TYPE)
07	C	TERMINAL CONNECTOR ON CB TO SUIT 3" IPS AL. TUBE (RIGID TYPE)
08	C	CONNECTOR ON PL TO SUIT 3" IPS AL. TUBE (RIGID TYPE)
09	C	CONNECTOR ON PL TO SUIT 3" IPS AL. TUBE (EXPANSION TYPE)
10	C	CONNECTOR ON TRAF0 TO SUIT 3" IPS AL. TUBE (ANGULAR FIXABLE)

INSULATORS & HARDWARES

S.NO.	EQPT. NO.	DESCRIPTION
01	I	SINGLE TENSION STRING ASSEMBLY CONSISTS OF 10 NOS. OF 11KV DISC INSULATORS EACH CLAMPING CREEPAGE DISTANCE OF 300MM ELECTROTHERMAL STRENGTH OF 120KV WITH TENSION CLAMP SUITABLE OR ACSR 'MOOSE' CONDUCTOR.

ACSR 'MOOSE' QUANTITY

S.NO.	EQPT. NO.	DESCRIPTION
01	A	'MOOSE' ACSR

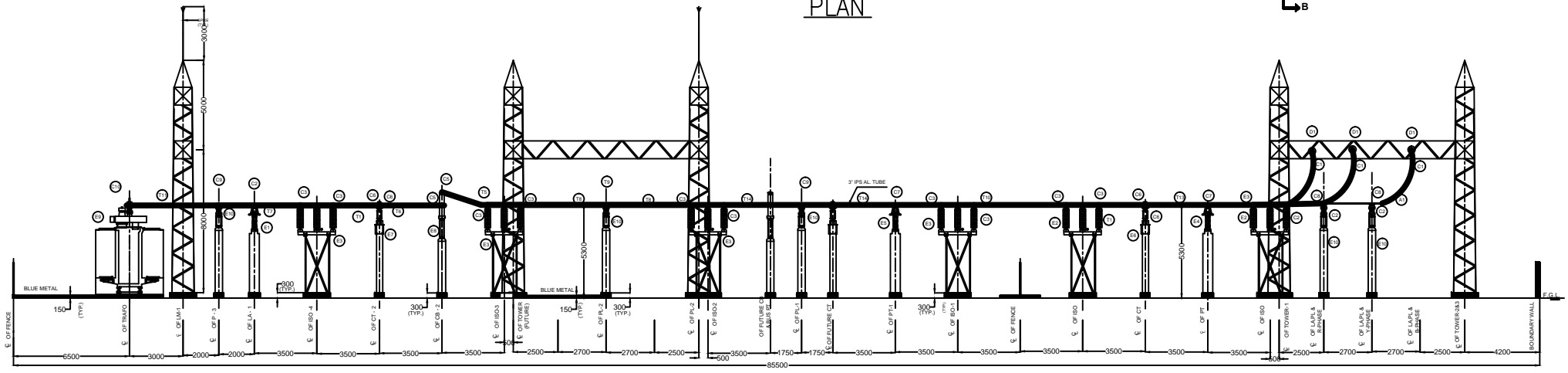

SECTION A-A

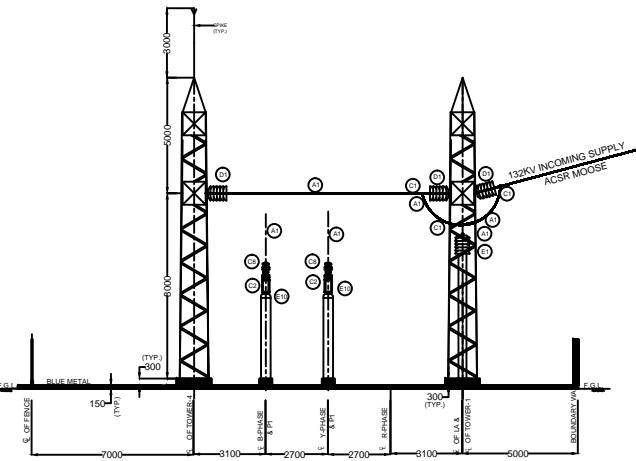

SECTION B-B

3"IPS AL. TUBE (SCHEDULE 10) CUT LENGTHS:

S.NO.	TUBE NO.	TUBE CUT LENGTH	NO. OF PIECES
01	T1	1985 MM	6 NOS
02	T2	2060 MM	1 NO.
03	T3	2900 MM	1 NO.
04	T4	3350 MM	1 NO.
05	T5	3125 MM	2 NOS
06	T6	3260 MM	2 NOS
07	T7	4260 MM	3 NOS
08	T8	4480 MM	6 NOS
09	T9	4500 MM	1 NO.
10	T10	4515 MM	1 NO.
11	T11	4700 MM	2 NOS
12	T12	4750 MM	1 NO.
13	T13	5485 MM	3 NOS
14	T14	5760 MM	6 NOS

REFERENCE DRAWINGS :-

1. FOR SWITCHYARD EQUIPMENT LAYOUT REFER DWG. NO. AL-EDS0405/VGL/01 - REV-01
2. FOR G.A. OF 132KV OUTDOOR OIL COOLED CURRENT TRANSFORMER REFER DRG. NO. 132-OC-01
3. FOR G.A. OF 132KV OUTDOOR OIL COOLED POTENTIAL TRANSFORMER REFER DRG. NO. 132-OP1
4. FOR G.A. OF 120KV-10KA GAPLESS SURGE ARRESTER REFER DRG. NO. ZHP-10-3-014
5. FOR G.A. OF 132KV SOLID CORE INSULATOR REFER DRG. NO. 999-062 - REV-0
6. FOR G.A. OF 145KV-40KA SF6 CIRCUIT BREAKER REFER DRG. NO. -G1099055-REV. -4
7. FOR G.A. OF 145KV/1250A, 40KA, 1200A DOUBLE BREAK MOTOR OPERATED ISOLATOR WITHOUT EARTH SWITCH REFER DRG. NO. -145RTH-016 - REV-1
8. FOR G.A. OF 145KV/1250A, 40KA, 1200A DOUBLE BREAK MOTOR OPERATED ISOLATOR WITH EARTH SWITCH REFER DRG. NO. -145RTHES-01 - REV-1